

THE INFORMATION CONTAINED IN THIS DRAWING IS THE SOLE PROPERTY OF L-COM, INC. ANY REPRODUCTION IN PART OR WHOLE WITHOUT THE WRITTEN PERMISSION OF L-COM, INC. IS PROHIBITED.

REVISION					
ZONE	REV	DESCRIPTION	DATE	CHANGED BY	APPROVED
	A	INITIAL RELEASE	01/04/2024	BZHANG	GUTTADAURO

D

C

B

A

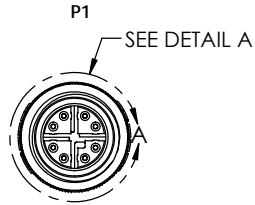

M12 SHIELD MALE  
8 POSITION X-CODED

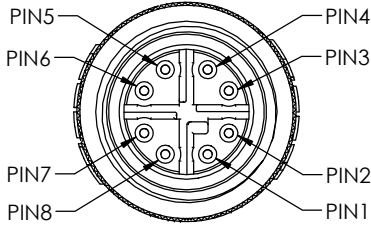

DETAIL A  
CONNECTOR PIN ASSIGNMENT

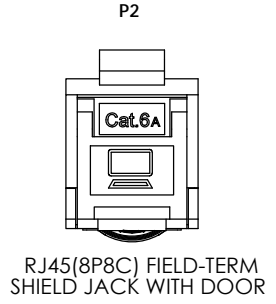
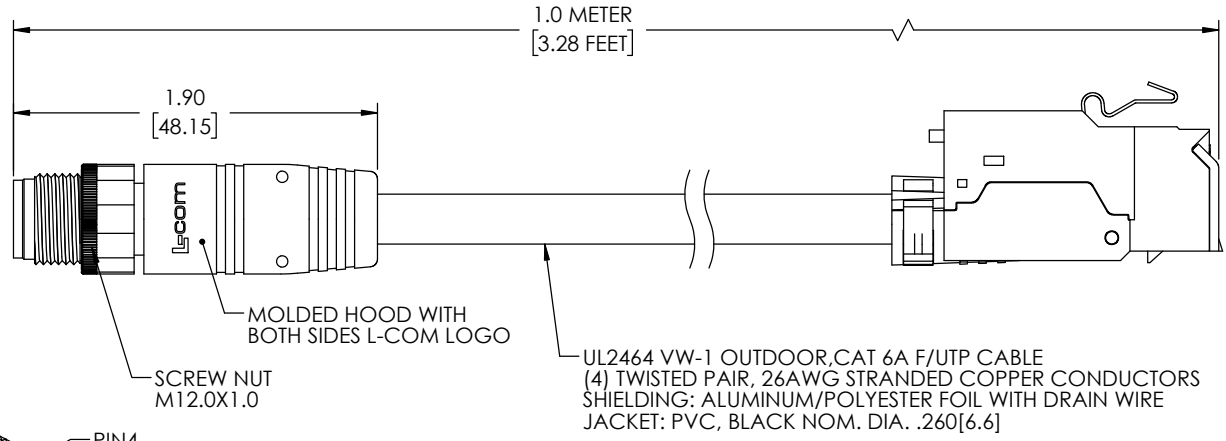

RJ45(8P8C) FIELD-TERM  
SHIELD JACK WITH DOOR

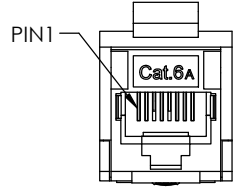

DOOR REMOVED  
FOR CLARITY

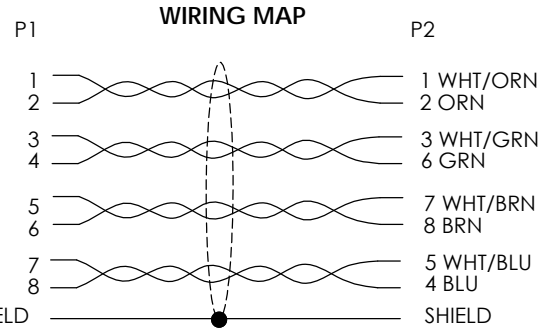

WIRING MAP

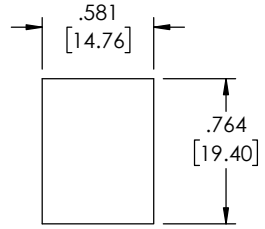

RECOMMENDED  
PANEL OPENING

**NOTES**

**MATERIAL:**  
 MOLDED HOOD: PVC, BLACK, UV RESISTANCE  
 M12 INSULATOR: NYLON, BLACK  
 M12 SHELL/SCREW NUT: BRASS, NICKEL PLATE  
 M12 CONTACTS: PHOSPHOR BRONZE, 15µ" MIN. GOLD PLATE  
 RJ45 JACK HOUSING/CAP: ZINC ALLOY DIE-CAST  
 RJ45 JACK INSULATOR: HIGH IMPACT FLAME RETARDANT PLASTIC  
 RJ45 JACK SPRING SHIELDING: COPPER ALLOY, NICKEL PLATE  
 RJ45 JACK CONTACTS: PHOSPHOR BRONZE, GOLD PLATE IN CONTACT AREA OVER NICKEL PLATE

**ELECTRICAL:**  
 VOLTAGE RATING: 48 VAC/VDC  
 CURRENT RATING: 0.5A

**APPLICATION:**  
 INGRESS PROTECTION RATING IS IP67 (MATED .P1 ONLY).

**ENVIRONMENTAL:**  
 OPERATING TEMPERATURE RANGE: -20°C TO +68°C  
 CABLE JACKET: UV RESISTANCE

**MISCELLANEOUS**  
 CABLE ASSEMBLIES TO BE TESTED FOR CONTINUITY WIRED TO IEC 61076-2-109 STANDARDS  
 CABLE ASSEMBLY SHALL BE INDIVIDUALLY PACKAGED IN ACCORDANCE WITH L-COM SPECIFICATION PS-0031.

UNLESS OTHERWISE SPECIFIED, DIMENSIONS ARE IN INCHES [mm] OVERALL CABLE LENGTH TOLERANCE: ≤12 [305] = +1 [25] / -0 >12 [305] ≤60 [1524] = +2 [51] / -0 >60 [1524] ≤120 [3048] = +4 [102] / -0 >120 [3048] ≤300 [7620] = +6 [152] / -0 >300 [7620] = +5% / -0 ALL OTHER DIMENSIONAL TOLERANCES: .X = ± .2 [5]   FRACTIONS ± 1/32 .XX = ± .02 [5]   ANGLES ± 1° .XXX = ± .005 [13]	APPROVALS	DATE	50 High Street, West Mill, North Andover, MA 01845 USA. Phone: 1.800.341.5266 1.978.682.6936
	DRAWN BY BZHANG	11/15/2023	
	CHECKED BY GUTTADAURO	11/15/2023	
	APPROVED BY GUTTADAURO	11/15/2023	
THIRD-ANGLE PROJECTION	CONFIGURATION DETAILS OF UNDIMENSIONED FEATURES MAY VARY	PRODUCT DESCRIPTION	TELECOM/MODULAR Cat6a M128X M/RRJ45 F/UTP 26AWG OD PVC BLK
COLOR VARIATIONS MAY OCCUR	SIZE <b>A</b>	CAGE CODE <b>43321</b>	
	DWG. NO. TRG625-C6B-1M	REV. <b>A</b>	
	SCALE: NONE	CAD FILE: TRG625-C6B-1M.SLDDRW	SHEET 1 OF 1