

THE INFORMATION CONTAINED IN THIS DRAWING IS THE SOLE PROPERTY OF SHOW ME CABLES, INC. ANY REPRODUCTION IN PART OR WHOLE WITHOUT THE WRITTEN PERMISSION OF SHOW ME CABLES, INC. IS PROHIBITED.

REVISIONS			
REV	DESCRIPTION	DATE	APPROVED
A	INITIAL RELEASE	8/30/2022	DGUITADAURO

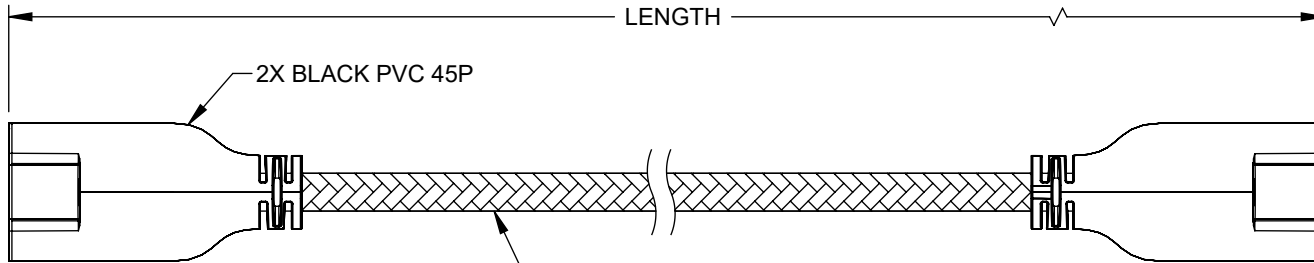
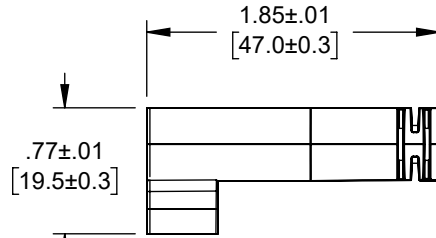

**P1**  
HDMI FM 19P PIN: G/F  
SHELL: GOLD PLATED

**P2**  
HDMI FM 19P PIN: G/F  
SHELL: GOLD PLATED

PIN Assignment

P1 HDMI AF	P2 HDMI AF
1	1
2	2
3	3
4	4
5	5
6	6
7	7
8	8
9	9
10	10
11	11
12	12
13	13
14	14
17	17
19	19
15	15
16	16
18	18
Shell	Shell

(1/0.23BC\*1P+D1/0.23BC+AL/MY)\*5P+1/0.23BC\*4C+AL/MY  
+D1/0.23BC+B64/0.12AM  
JACKET: BLACK PVC OD: 6.0  
+BLACK THREE WIRE NYLON NET OD: 6.8±0.2mm

PART NUMBER	LENGTH	
	FEET	METERS
LHD20-FF-1M	3.28	1.0 ± .03
LHD20-FF-3M	9.84	3.0 ± .03

- NOTES:**
- CABLE ASSEMBLY SHALL BE TESTED FOR CONTINUITY.
  - CABLE ASSEMBLY SHALL BE INDIVIDUALLY PACKAGED IN ACCORDANCE WITH L-COM SPECIFICATION PS-0031.

**REGULATORY COMPLIANCE:**  
EU RoHS DIRECTIVE (MOST RECENT RELEASED VERSION)

UNLESS OTHERWISE SPECIFIED, DIMENSIONS ARE IN INCHES [mm] OVERALL CABLE LENGTH TOLERANCE: ≤12 [305] = +1 [25] / -0 >12 [305] ≤60 [1524] = +2 [51] / -0 >60 [1524] ≤120 [3048] = +4 [102] / -0 >120 [3048] ≤300 [7620] = +6 [152] / -0 >300 [7620] = +5% / -0 ALL OTHER DIMENSIONAL TOLERANCES: .X = ± .2 [5]   FRACTIONS ± 1/32 .XX = ± .02 [5]   ANGLES ± 1° .XXX = ± .005 [1.3]	APPROVALS DRAWN BY DMAY CHECKED BY HBAKKE APPROVED BY DGUITADAURO	DATE 8/25/2022 8/30/2022 8/30/2022	 115 Chesterfield Industrial Blvd., Chesterfield, MO 63005 Phone: 1.888.519.9505 Fax: 1.888.519.9515
	THIRD-ANGLE PROJECTION 	CONFIGURATION DETAILS OF UNDIMENSIONED FEATURES MAY VARY COLOR VARIATIONS MAY OCCUR	CATEGORY AUDIO/VIDEO
SIZE <b>A</b>		CAGE CODE <b>3SVT8</b>	ITEM NO. LHD20-FF
SCALE: NONE		CAD FILE: LHD20-FF.SLDDRW	REV. <b>A</b>